

<JDBS-180> Specification of Direct Type-400W

- Note:1.The dimension of machine changes according to different motor and the motor lid is optional accessory.
 2.When you fill oil the sensor need to be back to home coordinate,and if you want to equip ball screw ,the sensor need to be backward more 50mm.
 3.We install the sensor outside.(right or left side) (optional accessory)
 4.Applicable motor:200,400W,750W.

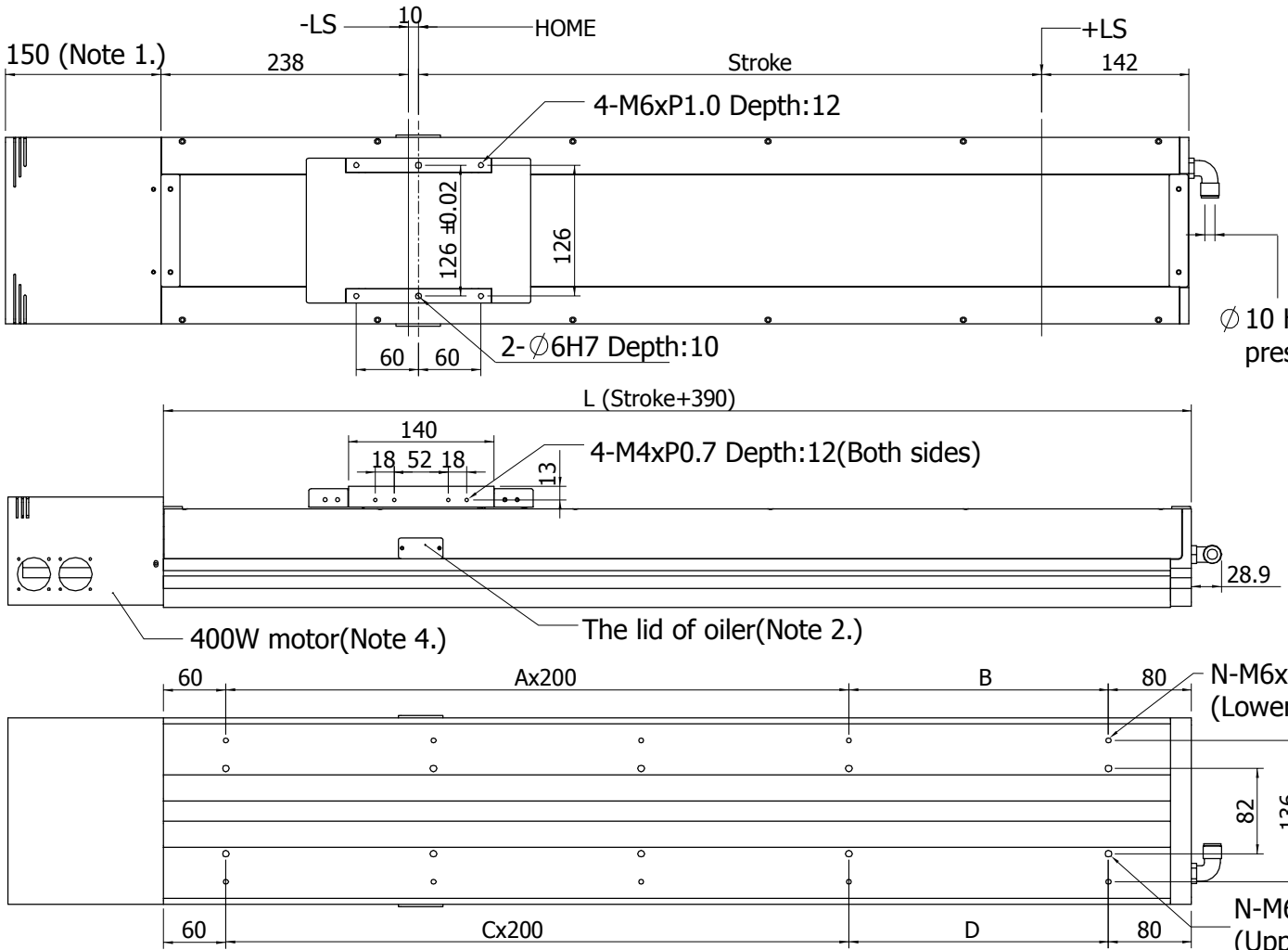

∅ 10 Hole of negative pressure exhaust.

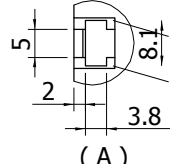

We install the Sensor outside. (Note 3.)

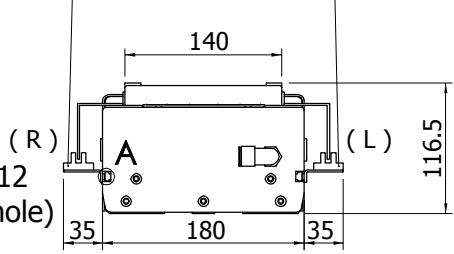

- SENSOR Operation:**
 1.+LS
 2.HOME
 3.-LS

Unit:mm

Stroke	100	200	300	400	500	600	700	800	900	1000	1100	1200	1300	1400	1500	1600	1700	1800	1900	2000	2100	2200
L	490	590	690	790	890	990	1090	1190	1290	1390	1490	1590	1690	1790	1890	1990	2090	2190	2290	2390	2490	2590
A	1	1	2	2	3	3	4	4	5	5	6	6	7	7	8	8	9	9	10	10	11	11
B	150	250	150	250	150	250	150	250	150	250	150	250	150	250	150	250	150	250	150	250	150	250
N	6	6	8	8	10	10	12	12	14	14	16	16	18	18	20	20	22	22	24	24	26	26
C	1	1	2	2	3	3	4	4	5	5	6	6	7	7	8	8	9	9	10	10	11	11
D	150	250	150	250	150	250	150	250	150	250	150	250	150	250	150	250	150	250	150	250	150	250
M	6	6	8	8	10	10	12	12	14	14	16	16	18	18	20	20	22	22	24	24	26	26
Weight(kg)	8.0	10.4	12.8	15.2	17.6	20.0	22.4	24.8	27.2	29.6	32	34.4	36.8	39.2	41.6	44.0	45.2	46.4	47.8	49.0	50.2	51.4
Rpm	3000	3000	3000	3000	3000	3000	2500	2000	2000	2000	2000	1500	1500	1500	1500	1500	1500	1200	1200	1200	1000	1000